



JAMIE WARNER  
— ESTATE AGENTS —



## 25 Dane Close, Kedington, Suffolk, CB9 7NX

Guide Price £340,000

- Three Bedrooms
- Conservatory
- Popular Village Location
- Sitting Room
- South Facing Garden
- Kitchen /Dining Room
- Views Over Open Fields

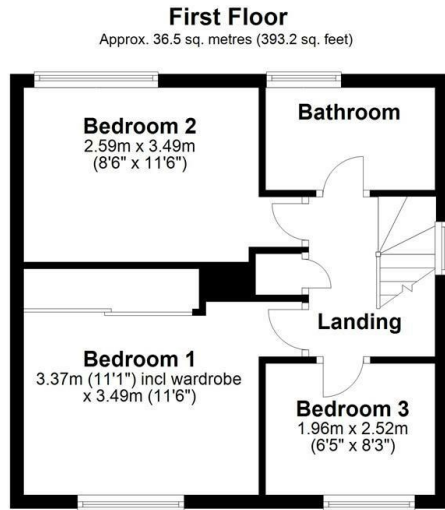
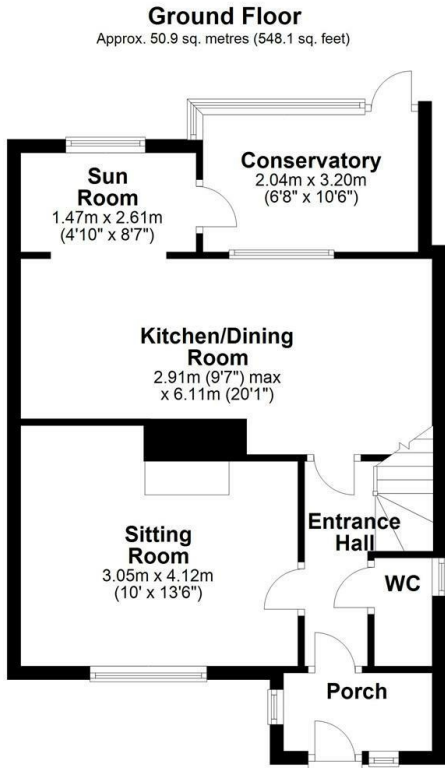

Total area: approx. 87.5 sq. metres (941.4 sq. feet)

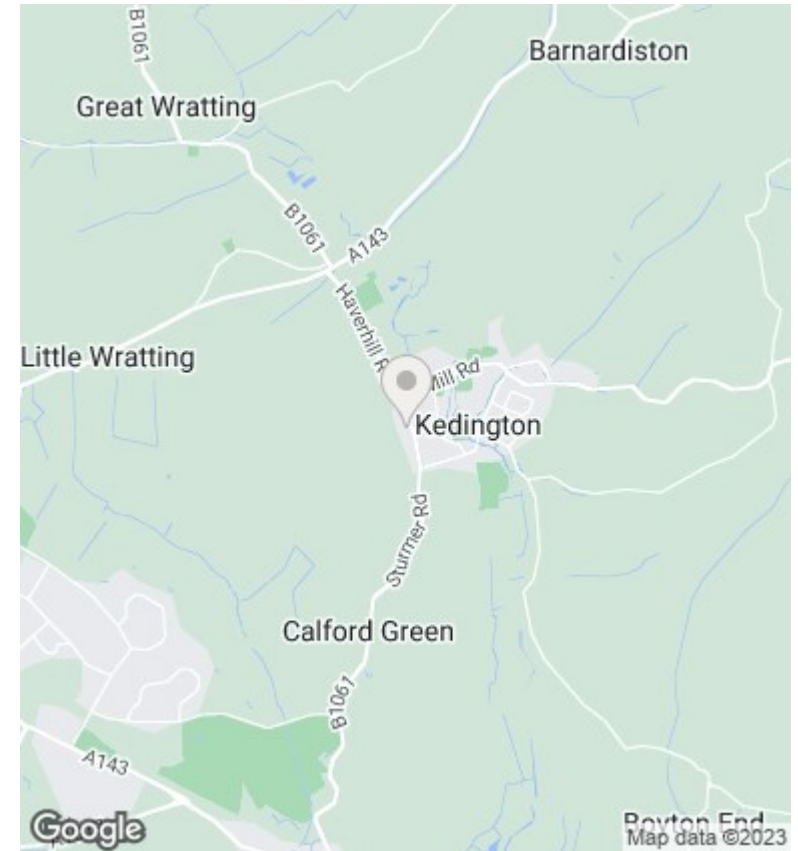

## Directions

## Viewings

Viewings by arrangement only. Call 01440 712221 to make an appointment.

## Council Tax Band

## EPC Rating:

Energy Efficiency Rating		
	Current	Potential
<i>Very energy efficient - lower running costs</i>		
(92 plus) <b>A</b>		
(81-91) <b>B</b>		
(69-80) <b>C</b>		
(55-68) <b>D</b>		
(39-54) <b>E</b>		
(21-38) <b>F</b>		
(1-20) <b>G</b>		
<i>Not energy efficient - higher running costs</i>		
<b>England &amp; Wales</b>	EU Directive 2002/91/EC	